

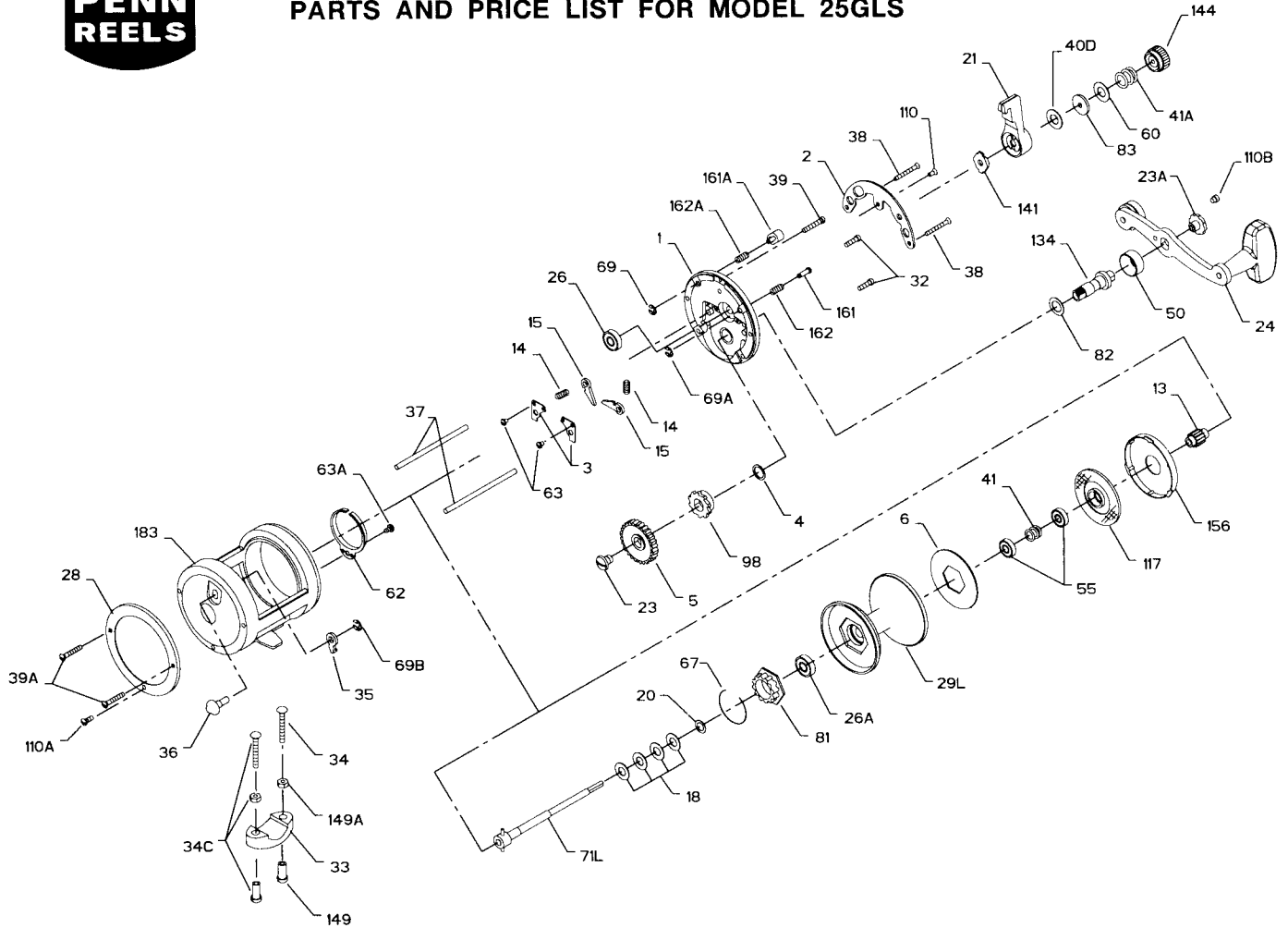

## PARTS AND PRICE LIST FOR MODEL 25GLS



Key No.	Part No.	Description	Price	Key No.	Part No.	Description	Price
1	1N-25	Right Side Plate	\$9.45	41A	41-25	Bearing Spring	.70
2	2-25	Quadrant Ring	5.70	50	50-25	Gear Stud Cover	2.70
3	3N-25	Dog Bridge (2 req.)	2.30	55	55-116	Spool Bearing (2 req.)	13.50
4	4-25	Gear Stud Washer	.50	60	60-25	Lever Backing Washer	1.00
5	5-25	Main Gear	8.00	62	62-25	Click Spring	1.75
6	6-25	Drag Washer	7.15	63	63-500S	Bridge Mounting Screw (2 req.)	.80
13	13N-25	Pinion Gear	6.65	63A	63-500S	Click Spring Screw	.80
14	14-40	Dog Spring (2 req.)	.60	67	67-25	Ratchet Retaining Ring	.80
15	15N-25	Dog (2 req.)	1.35	69	69B-50	Strike Button Retaining Ring	.80
18	18-40	Clutch Disc Spring (4 req.)	.80	69A	69B-50	Free Spool Button Retaining Ring	.80
20	20-40	Thrust Washer	.40	69B	69B-600	Click Tongue Retaining Ring	.90
21	21R-25	Cam Lever	4.90	71L	71L-25	Spool Spindle Assembly	8.10
21B	*21B-40	Cam Lever Insert	.45	81	81-25	Click Ratchet	2.70
23	23-6	Gear Mounting Screw	1.25	82	82-25	Handle Shim	.40
23A	23-114	Handle Screw	2.65	83	83-25	Pre-Set Collar	2.70
24	24-320	Handle	7.75	98	98-25	Main Gear Ratchet	1.50
26	26N-25	Ball Bearing Drive Plate	13.25	110	110-50	R.S. Quadrant Screw	.50
26A	26N-25	L.S. Spool Bearing	13.25	110A	110-50	L.S. Stand Screw	.50
28	28-25	L.S. Ring	6.40	110B	110-60	Handle Lock Screw	.40
29L	29L-25	Spool	38.50	117	117-25	Drive Plate Assembly	10.30
32	32-22	Lower Plate Screw (2 req.)	.40	134	134-25	Gear Stud	4.75
33	33-113	Rod Clamp	4.00	134A	*134A-25	Gear Stud Washer	.50
	*33R-200	Ringed Rod Clamp (Optional)	6.25	141	141-25	Cam Follower	2.95
34	34-45	Clamp Screw (Only)	.90	144	144-25	Pre-Set Knob	6.10
34C	34C-45	Rod Clamp Screw w/Nuts	2.25	149	149-45	Clamp Nut (2 req.)	.90
35	35-25	Click Tongue	1.10	149A	149-200	Hex Nuts (2 req.)	.45
36	36-25	Click Button	.80	156	156-25	Drag Cover	2.70
37	37-40	Post (2 req.)	1.95	161	161-25	Free Spool Button	1.25
38	38-40	R.S. Post Screw (2 req.)	.40	161A	161-40	Strike Button	1.25
39	39-1	R.S. Screw (Top)	.40	162	162-50	Free Spool Button Spring	.45
39A	39-9	L.S. Post Screw (2 req.)	.40	162A	162-50	Strike Button Spring	.45
40D	40D-25	Friction Washer	.50	183	183-25	Frame	32.50
41	41-40	Pre-Set Knob Spring	.80				

\*Not Shown